

SmartScan: ⇒ New User Interface

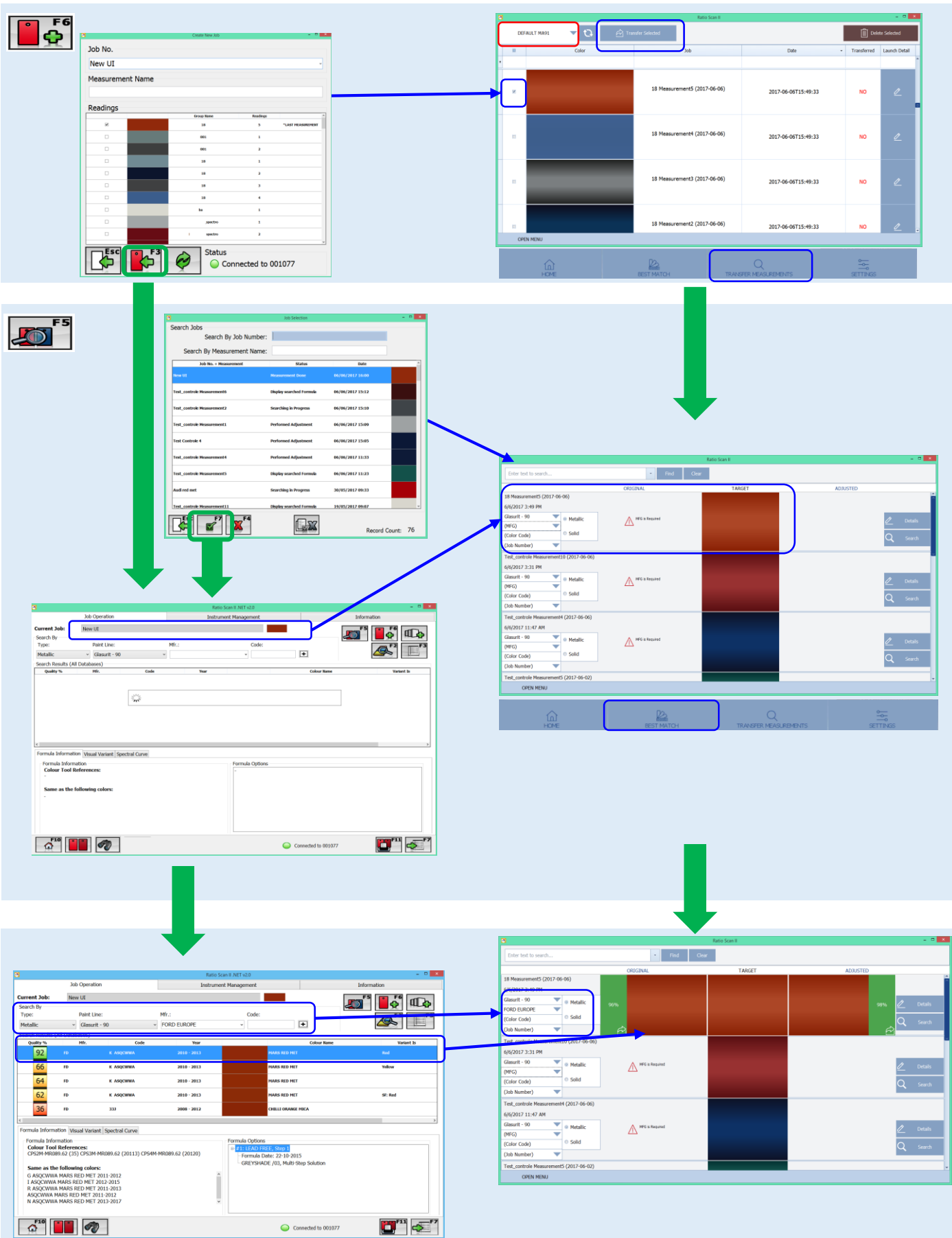

Options

Current Job: New UI

Search By: Type: Metallic; Paint Line: Glasurit - 90; Mfr.: FORD EUROPE; Code: []

Search Results (All Databases):

Quality %	Base	Name	Grain	Year	Color Name	Variant %
92	FD	K ASQCWVA	2010-2013	MARS RED MET	Yellow	
66	FD	K ASQCWVA	2010-2013	MARS RED MET		
64	FD	K ASQCWVA	2010-2013	MARS RED MET		
62	FD	K ASQCWVA	2010-2013	MARS RED MET		
36	FD	333	2008-2012	CHILLI ORANGE MICA		

Formula Information (Visual Variant | Spectral Curve):

Colour Tool Reference: CP53M-MR089.62 (2011) CP54M-MR089.62 (2010)

Same as the following colors:
 G ASQCWVA MARS RED MET 2011-2012
 I ASQCWVA MARS RED MET 2012-2015
 K ASQCWVA MARS RED MET 2010-2013
 ASQCWVA MARS RED MET 2011-2012
 N ASQCWVA MARS RED MET 2013-2017

Formula Options: 1: 13-11-2011; 2: 22-10-2015; GREYSHADE (0), Multi Step Solution

SEARCH CRITERIA: RESULTS | SPECTRAL CURVE | COLOR VISUALIZATION

18 Measurements (2017-06-06) | 6/6/2017 3:49:33 PM | // | Glasurit - 90 | METALLIC

Color Name	Match %	Target	Adjusted
FORD EUROPE	96%		98%
K - MARS RED MET			
2010-2013			
FORD EUROPE			
K - MARS RED MET	74%		86%
2010-2013			
STANDARD			
FORD EUROPE			
K - MARS RED MET	72%		85%
SF80 - RED			
FORD EUROPE			
333 - CHILLI ORANGE MICA			

Like Colors (button)

Details (button)

92 Original Quality

98 Adjusted Quality

Base	Orig. Amt.	Adj. Amt.	Diff. Amt.
M1	376.50	376.50	-0.00
E200	86.40	90.80	+2.40
E280	16.30	16.00	-0.30
M99/21	1.70	3.20	+1.50
A143	123.70	123.80	+0.10
A176	61.60	61.70	+0.10
A333	41.80	51.30	+9.50
A306	6.00	6.70	+0.70
E3	53.40	56.40	+3.00

SEARCH CRITERIA: RESULTS | SPECTRAL CURVE | COLOR VISUALIZATION

18 Measurements (2017-06-06) | 6/6/2017 3:49:33 PM

Formula: CP53M-MR089.62 (2011) CP54M-MR089.62 (2010)

Color Visualization: Original | Target | Adjusted

Match: 96% | Target: [] | Adjusted: 98%

92 Original Formula | **98 Adjusted Formula** | **Details**

Base	Name	Grain	Base	Name	Grain
M1	M1	376.50	M1	M1	376.50
E200	E200	86.40	E200	E200	90.80
E280	E280	16.30	E280	E280	16.00
M99/21	M99/21	1.70	M99/21	M99/21	3.20
A143	A143	123.70	A143	A143	123.80
A176	A176	61.60	A176	A176	61.70
A333	A333	41.80	A333	A333	51.30
A306	A306	6.00	A306	A306	6.70
E3	E3	53.40	E3	E3	56.40



Information: Visual Variant | Graph View

Graph showing color differences between original and adjusted formulas.

SEARCH CRITERIA: RESULTS | SPECTRAL CURVE | COLOR VISUALIZATION

18 Measurements (2017-06-06) | 6/6/2017 3:49:33 PM

Color Visualization: Original | Target | Adjusted

Match: 96% | Target: [] | Adjusted: 98%

Legend: Match (red), Target (green), Adjusted (blue)

Current Job: New UI

Search By: Type: Metallic; Paint Line: Glasurit - 90; Mfr.: []; Code: []

Search Database: Gloss: ALL; Color Tool: ALL

SEARCH CRITERIA: RESULTS | SPECTRAL CURVE | COLOR VISUALIZATION

18 Measurements (2017-06-06) | 6/6/2017 3:49:33 PM

Paintline: Glasurit - 90

Manufacturer: FORD EUROPE

Database: ALL

Color Code: ALL

Coating: ALL

Color Tool: ALL

92 Original Formula | **98 Adjusted Formula** | **Details**

Base	Name	Grain	Base	Name	Grain
M1	M1	376.50	M1	M1	376.50
E200	E200	86.40	E200	E200	90.80
E280	E280	16.30	E280	E280	16.00
M99/21	M99/21	1.70	M99/21	M99/21	3.20
A143	A143	123.70	A143	A143	123.80
A176	A176	61.60	A176	A176	61.70
A333	A333	41.80	A333	A333	51.30
A306	A306	6.00	A306	A306	6.70
E3	E3	53.40	E3	E3	56.40

Information: Visual Variant | Graph View

SEARCH CRITERIA: RESULTS | SPECTRAL CURVE | COLOR VISUALIZATION

18 Measurements (2017-06-06) | 6/6/2017 3:49:33 PM

Formula: CP53M-MR089.62 (2011) CP54M-MR089.62 (2010)

Spectral Curve Graph: Original (red), Target (green), Adjusted (blue)

Legend: Match (red), Target (green), Adjusted (blue)